



Certificate of Acceptance of new water and/or wastewater assets

Watercare Reference Number
COMP-1945

Auckland Council EPA number
ENG60344359

Site Details

Job Name			
Legal site address: Street number	17	Street name	Old Pine Valley ROAD
Suburb	Pine Valley	Postcode	0992
Lot number		Deposited plan (DP) number	
		Certificate of Title (CT) number	
Stage/s that relates to this certificate	MILLADALE STAGE 3C		

Certification Statement

Watercare has received the following documentation:

As-built (PDF) As-built CAD (DWG) Watercare Schedule of assets CS3 CS4

This Watercare Certificate of Acceptance is issued with respect to all aspects of the engineering water and/or wastewater works covered by the above engineering plan approval and to satisfy Auckland Council's engineering approval completion certificate.

The assets have been connected correctly to the existing public networks.

The total value of these assets to be vested to Auckland Council is: \$ 685,294.23

Watercare Representative

Full Name Michael Toki

Signature

Date

13/08/2020

Lot No.	Easting (m)	Northing (m)
Lot 480	1747767.47	5946137.49
Lot 481	1747775.77	5946117.85
Lot 482	1747786.07	5946102.98
Lot 483	1747815.60	5946118.86
Lot 484	1747804.74	5946138.02
Lot 485	1747796.27	5946152.88
Lot 506	1747837.28	5946175.23
Lot 507	1747869.24	5946146.97
Lot 508	1747885.73	5946156.46
Lot 509	1747900.44	5946165.15
Lot 510	1747916.68	5946174.59
Lot 511	1747930.14	5946182.39
Lot 512	1747932.89	5946184.03
Lot 513	1747958.88	5946199.09
Lot 515	1747929.87	5946224.97
Lot 516	1747919.86	5946219.93
Lot 517	1747903.19	5946211.21
Lot 518	1747885.60	5946201.77
Lot 519	1747872.13	5946194.55
Lot 520	1747855.60	5946185.78
Lot 521	1747834.22	5946231.93
Lot 522	1747825.10	5946247.76
Lot 523	1747817.99	5946260.97
Lot 524	1747810.75	5946274.01
Lot 525	1747801.68	5946289.94
Lot 526	1747794.32	5946302.97
Lot 527	1747787.12	5946315.91
Lot 528	1747779.11	5946329.89
Lot 529	1747771.34	5946344.02
Lot 530	1747763.52	5946357.91
Lot 531	1747755.09	5946372.05
Lot 532	1747791.31	5946396.41
Lot 533	1747799.48	5946382.73
Lot 534	1747808.06	5946367.52
Lot 535	1747815.96	5946353.40
Lot 536	1747824.14	5946338.29
Lot 537	1747831.32	5946325.66
Lot 538	1747838.19	5946313.31
Lot 539	1747846.93	5946297.99
Lot 540	1747855.82	5946282.09
Lot 541	1747863.36	5946268.36
Lot 542	1747872.32	5946252.33
Lot 543	1747884.81	5946263.52
Lot 544	1747885.32	5946280.57
Lot 545	1747877.03	5946295.29
Lot 546	1747867.56	5946311.97
Lot 547	1747859.13	5946326.80
Lot 548	1747851.07	5946341.42
Lot 549	1747845.30	5946350.43
Lot 550	1747898.87	5946346.42
Lot 551	1747913.40	5946353.34
Lot 552	1747927.82	5946360.39
Lot 553	1747943.34	5946367.67
Lot 554	1747955.90	5946373.67
Lot 555	1747968.70	5946379.83
Lot 556	1747982.22	5946386.26
Lot 557	1747998.52	5946393.86
Lot 558	1748017.45	5946352.72
Lot 559	1748002.82	5946346.45
Lot 560	1747988.43	5946339.23
Lot 561	1747972.04	5946331.34
Lot 562	1747956.66	5946323.81
Lot 563	1747943.11	5946317.49
Lot 564	1747915.62	5946313.65
Lot 565	1747923.50	5946298.85
Lot 566	1747931.96	5946282.71
Lot 567	1747956.07	5946291.87
Lot 568	1747968.95	5946297.77
Lot 569	1747983.21	5946305.23
Lot 570	1748000.63	5946313.92
Lot 571	1748012.89	5946319.68
Lot 572	1748029.04	5946327.22
Lot 574	1748033.29	5946276.00
Lot 575	1748004.44	5946262.78
Lot 576	1747986.30	5946254.04
Lot 577	1747969.85	5946246.07
Lot 578	1747964.80	5946243.27
Lot 579	1747982.75	5946213.30
Lot 580	1747998.22	5946222.10
Lot 581	1748005.48	5946225.63
Lot 582	1748022.03	5946231.11
Lot 583	1748039.99	5946237.08
Lot 584	1748056.18	5946243.72

DISCLAIMER:
 THE INFORMATION PORTRAYED ON THIS PLAN IS INTENDED TO BE SOLELY USED AS THE BASE DATA FOR THE PURPOSES OF 224C APPLICATION TO COUNCIL. FULTON HOGAN LAND DEVELOPMENT AND WOOD AND PARTNERS CONSULTANTS ACCEPT NO RESPONSIBILITY FOR ANY BUILDING DESIGN OR CONSTRUCTION WORK BASED ON THIS DRAWING FILE.

I certify that these As-built Plans are an accurate record of the works undertaken and that:
 The coordinates (X,Y) are in terms of NZTM on NZGD2000
 The Levels (Z) are in terms of Auckland Vertical Datum 1946 (MSL) LINZ datum

Signed: _____
 Registered Professional Surveyor

Date: 25/06/20

Name: JAMIE WHYTE

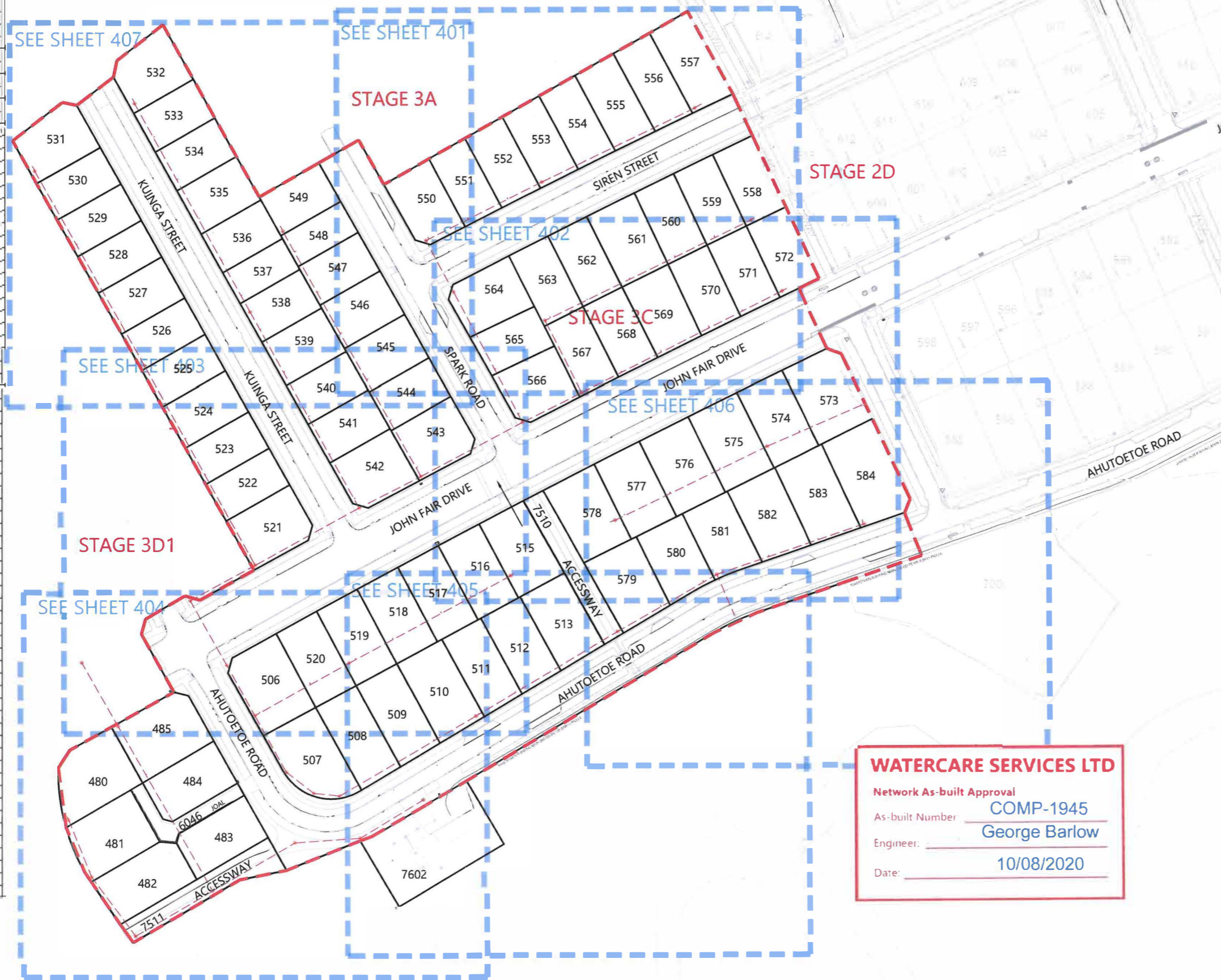

LEGEND

NEW SANITARY SEWER MANHOLE	●
NEW SANITARY SEWER	---
EXISTING SANITARY SEWER	---
LOT BOUNDARIES	---
STAGE BOUNDARY	----
UNCONFIRMED DATA	WARNING LNS!!
EXISTING DATA ADJUSTED	LL= 23.74
INVERT HAS DROP-PIPE STRUCTURE	DPS

- NOTES**
- ALL WORKS AND MATERIALS COMPLY WITH AUCKLAND COUNCIL & WATERCARE SERVICES LTD STANDARDS FOR ENGINEERING DESIGN AND CONSTRUCTION.
 - ALL SANITARY SEWER LINES ARE 150mmØ uPVC CLASS SN16 UNLESS STATED OTHERWISE.
 - ALL PIPE BEDDING COMPLIES WITH WATERCARE STANDARDS.
 - ALL PIPE CROSSINGS UNDER ROADS AND ACCESSWAYS HAVE BEEN HARDFILL BACKFILLED.
 - ALL PRIVATE LOT CONNECTIONS ARE 100mmØ
 - LOT BOUNDARIES ARE SUBJECT TO FINAL SURVEY.
 - ALL PIPE AND MH DIAMETERS ARE INTERNAL, AND SHOWN IN MILLIMETERS UNLESS OTHERWISE SPECIFIED.
 - ASBUILT DATA HAS BEEN SOURCED FROM A COMBINATION OF WOODS SURVEY MEASURED DATA AND CONTRACTOR RECEIVED DATA.

REVISION DETAILS	BY	DATE
1 ISSUED FOR INFORMATION	KR	25/06/20

SURVEYED	WOODS	WOODS Ltd LEVEL 1 BUILDING B 8 NUGENT STREET, GRAFTON AUCKLAND 1023 09 308 9229 WOODS.CO.NZ
DESIGNED	NM	
DRAWN	HP	
CHECKED	KR	
APPROVED	JW	



WATERCARE SERVICES LTD
 Network As-built Approval
 As-built Number: COMP-1945
 Engineer: George Barlow
 Date: 10/08/2020

MILLDALE
 STAGE 3C
 WASTEWATER ASBUILT
 OVERALL LAYOUT
 SHEET 1 of 8

STATUS	ASBUILT	REV
SCALE	1:1500 @ A3	1
COUNCIL	AUCKLAND COUNCIL	
DWG NO	P18-305-03C-400-AB	

DISCLAIMER:
 THE INFORMATION PORTRAYED ON THIS PLAN IS INTENDED TO BE SOLELY USED AS THE BASE DATA FOR THE PURPOSES OF 224C APPLICATION TO COUNCIL. FULTON HOGAN LAND DEVELOPMENT AND WOOD AND PARTNERS CONSULTANTS ACCEPT NO RESPONSIBILITY FOR ANY BUILDING DESIGN OR CONSTRUCTION WORK BASED ON THIS DRAWING FILE.

I certify that these As-built Plans are an accurate record of the works undertaken and that:
 • The coordinates (X,Y) are in terms of NZTM on NZGD2000
 • The Levels (Z) are in terms of Auckland Vertical Datum 1946 (MSL) LINZ datum

Signed: J Whyte
 Registered Professional Surveyor

Date: 25/06/20

Name: JAMIE WHYTE

WATERCARE SERVICES LTD
 Network As-built Approval
 As-built Number: COMP-1945
 Engineer: George Barlow
 Date: 10/08/2020



STAGE 3A

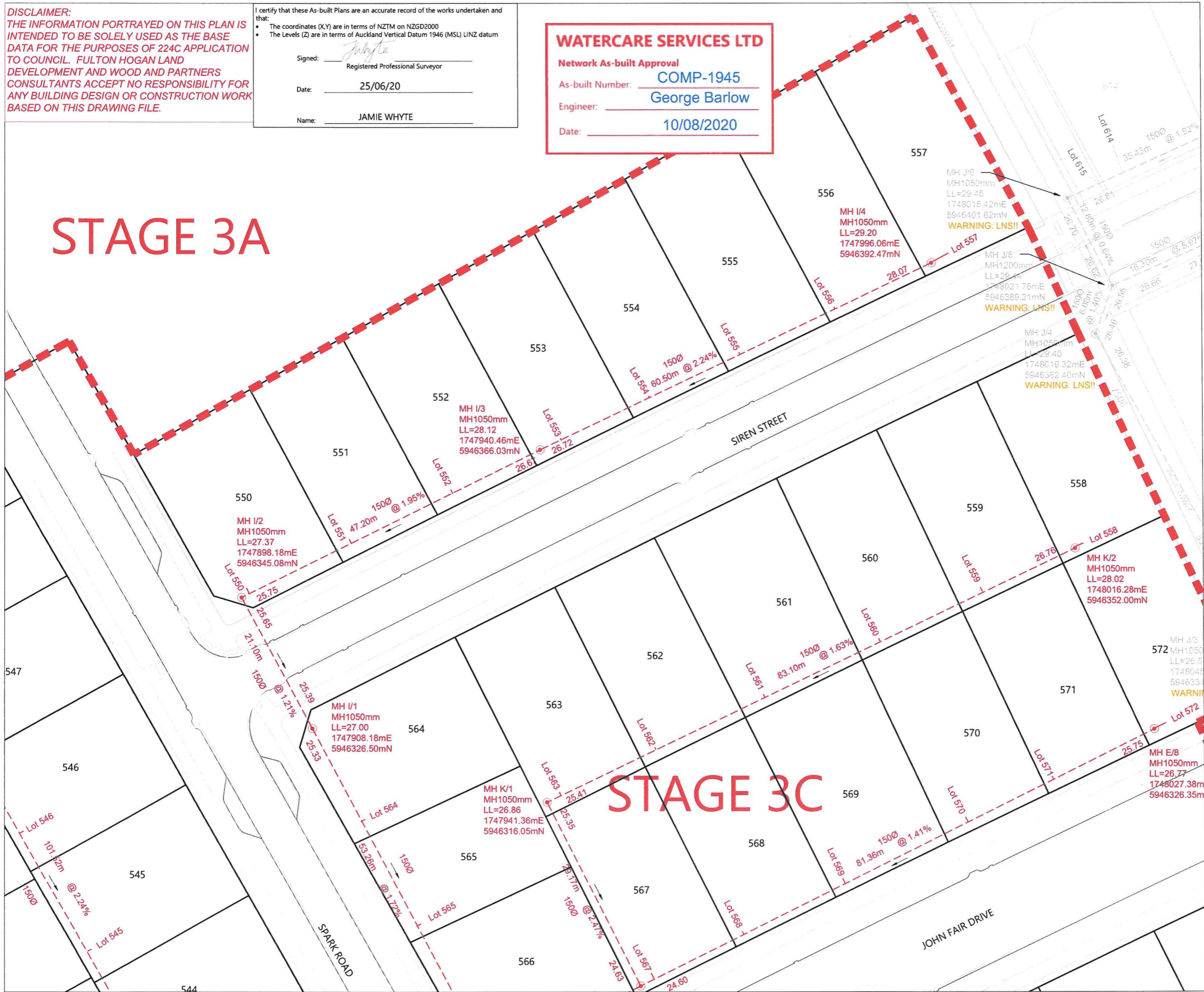

STAGE 3C

LEGEND

NEW SANITARY SEWER MANHOLE	
NEW SANITARY SEWER	
EXISTING SANITARY SEWER	
LOT BOUNDARIES	
STAGE BOUNDARY	
UNCONFIRMED DATA	WARNING: LNS!!
EXISTING DATA ADJUSTED	LL=23.74
INVERT HAS DROP-PIPE STRUCTURE	DPS

- NOTES**
1. ALL WORKS AND MATERIALS COMPLY WITH AUCKLAND COUNCIL & WATERCARE SERVICES LTD STANDARDS FOR ENGINEERING DESIGN AND CONSTRUCTION.
 2. ALL SANITARY SEWER LINES ARE 150mmØ uPVC CLASS SN16 UNLESS STATED OTHERWISE.
 3. ALL PIPE BEDDING COMPLIES WITH WATERCARE STANDARDS.
 4. ALL PIPE CROSSINGS UNDER ROADS AND ACCESSWAYS HAVE BEEN HARDFILL BACKFILLED.
 5. ALL PRIVATE LOT CONNECTIONS ARE 100mmØ
 6. LOT BOUNDARIES ARE SUBJECT TO FINAL SURVEY.
 7. ALL PIPE AND MH DIAMETERS ARE INTERNAL, AND SHOWN IN MILLIMETERS UNLESS OTHERWISE SPECIFIED.
 8. ASBUILT DATA HAS BEEN SOURCED FROM A COMBINATION OF WOODS SURVEY MEASURED DATA AND CONTRACTOR RECEIVED DATA.

REVISION DETAILS	BY	DATE
1 ISSUED FOR INFORMATION	KR	25/06/20

SURVEYED	WOODS	WOODS Ltd LEVEL 1 BUILDING B 8 NUGENT STREET, GRAFTON AUCKLAND 1023
DESIGNED	NM	
DRAWN	HP	
CHECKED	KR	
APPROVED	JW	
		09 308 9229
		WOODS.CO.NZ

N

MILLDALE
 Consulting Engineers

MILLDALE
STAGE 3C
 WASTEWATER ASBUILT
 OVERALL LAYOUT
 SHEET 2 of 8

STATUS	ASBUILT	REV
SCALE	1 : 500 @ A3	1
COUNCIL	AUCKLAND COUNCIL	
DWG NO	P18-305-03C-401-AB	

WATERCARE SERVICES LTD

Network As-built Approval
 As-built Number: **COMP-1945**
 Engineer: **George Barlow**
 Date: **10/08/2020**

DISCLAIMER:
 THE INFORMATION PORTRAYED ON THIS PLAN IS INTENDED TO BE SOLELY USED AS THE BASE DATA FOR THE PURPOSES OF 224C APPLICATION TO COUNCIL. FULTON HOGAN LAND DEVELOPMENT AND WOOD AND PARTNERS CONSULTANTS ACCEPT NO RESPONSIBILITY FOR ANY BUILDING DESIGN OR CONSTRUCTION WORK BASED ON THIS DRAWING FILE.

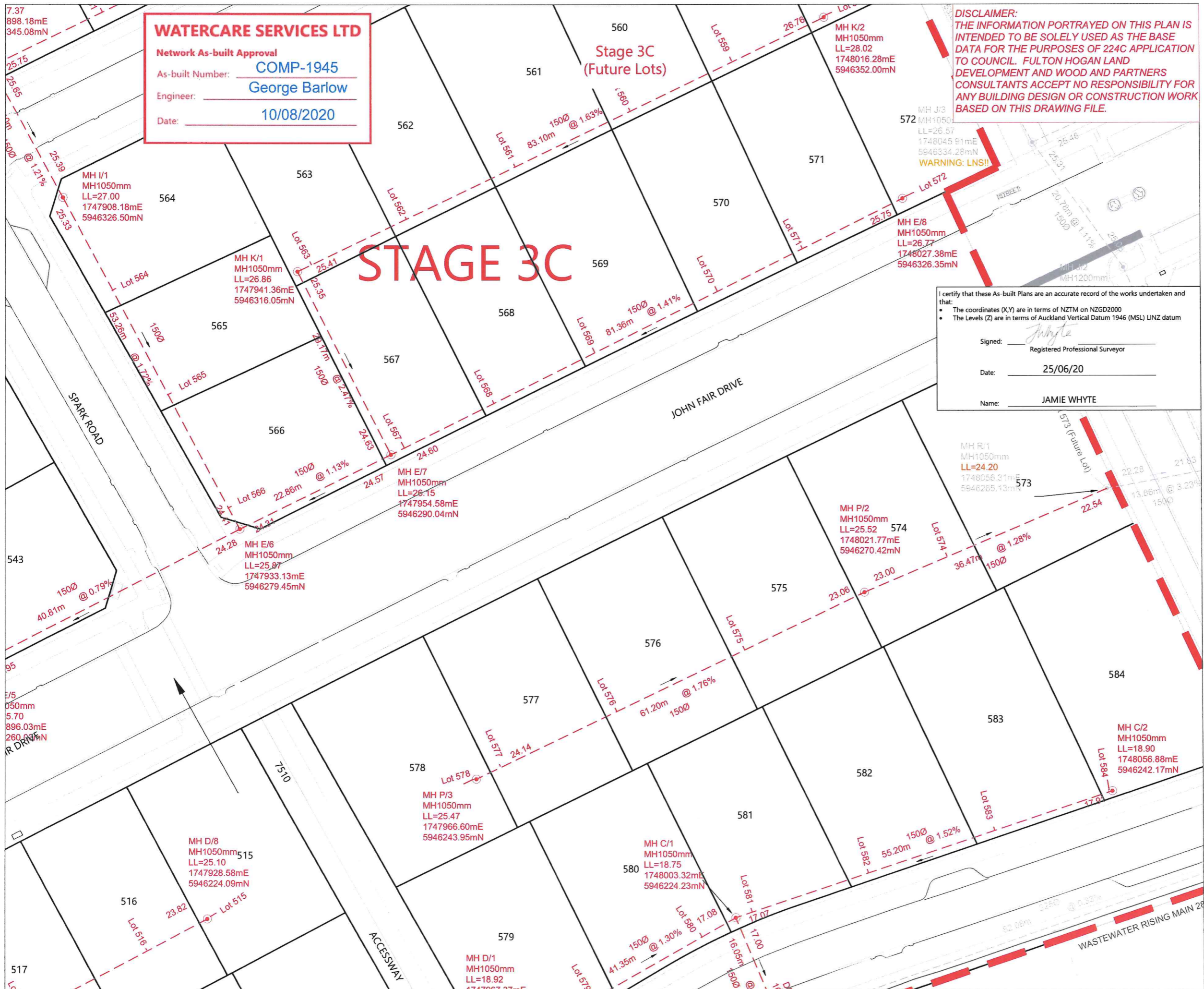

I certify that these As-built Plans are an accurate record of the works undertaken and that:

- The coordinates (X,Y) are in terms of NZTM on NZGD2000
- The Levels (Z) are in terms of Auckland Vertical Datum 1946 (MSL) LINZ datum

Signed: *J Whyte*
 Registered Professional Surveyor
 Date: **25/06/20**
 Name: **JAMIE WHYTE**

LEGEND

NEW SANITARY SEWER MANHOLE	●
NEW SANITARY SEWER	---
EXISTING SANITARY SEWER	---
LOT BOUNDARIES	---
STAGE BOUNDARY	---
UNCONFIRMED DATA	---
EXISTING DATA ADJUSTED	LL=23.74
INVERT HAS DROP-PIPE STRUCTURE	DPS

- NOTES**
- ALL WORKS AND MATERIALS COMPLY WITH AUCKLAND COUNCIL & WATERCARE SERVICES LTD STANDARDS FOR ENGINEERING DESIGN AND CONSTRUCTION.
 - ALL SANITARY SEWER LINES ARE 150mmØ uPVC CLASS SN16 UNLESS STATED OTHERWISE.
 - ALL PIPE BEDDING COMPLIES WITH WATERCARE STANDARDS.
 - ALL PIPE CROSSINGS UNDER ROADS AND ACCESSWAYS HAVE BEEN HARDFILL BACKFILLED.
 - ALL PRIVATE LOT CONNECTIONS ARE 100mmØ
 - LOT BOUNDARIES ARE SUBJECT TO FINAL SURVEY.
 - ALL PIPE AND MH DIAMETERS ARE INTERNAL, AND SHOWN IN MILLIMETERS UNLESS OTHERWISE SPECIFIED.
 - ASBUILT DATA HAS BEEN SOURCED FROM A COMBINATION OF WOODS SURVEY MEASURED DATA AND CONTRACTOR RECEIVED DATA.

REVISION DETAILS

	BY	DATE
1	ISSUED FOR INFORMATION	KR 25/06/20
2	R/1 DPS NOTE REMOVED	SK 05/08/20

SURVEYED	WOODS	WOODS Ltd LEVEL 1 BUILDING B 8 NUGENT STREET, GRAFTON AUCKLAND 1023 09 308 9229 WOODS.CO.NZ
DESIGNED	NM	
DRAWN	HP	
CHECKED	KR	
APPROVED	JW	



MILLDALE
STAGE 3C
 WASTEWATER ASBUILT
 OVERALL LAYOUT
 SHEET 3 of 8

STATUS	ASBUILT	REV
SCALE	1:500 @ A3	2
COUNCIL	AUCKLAND COUNCIL	
DWG NO	P18-305-03C-402-AB	

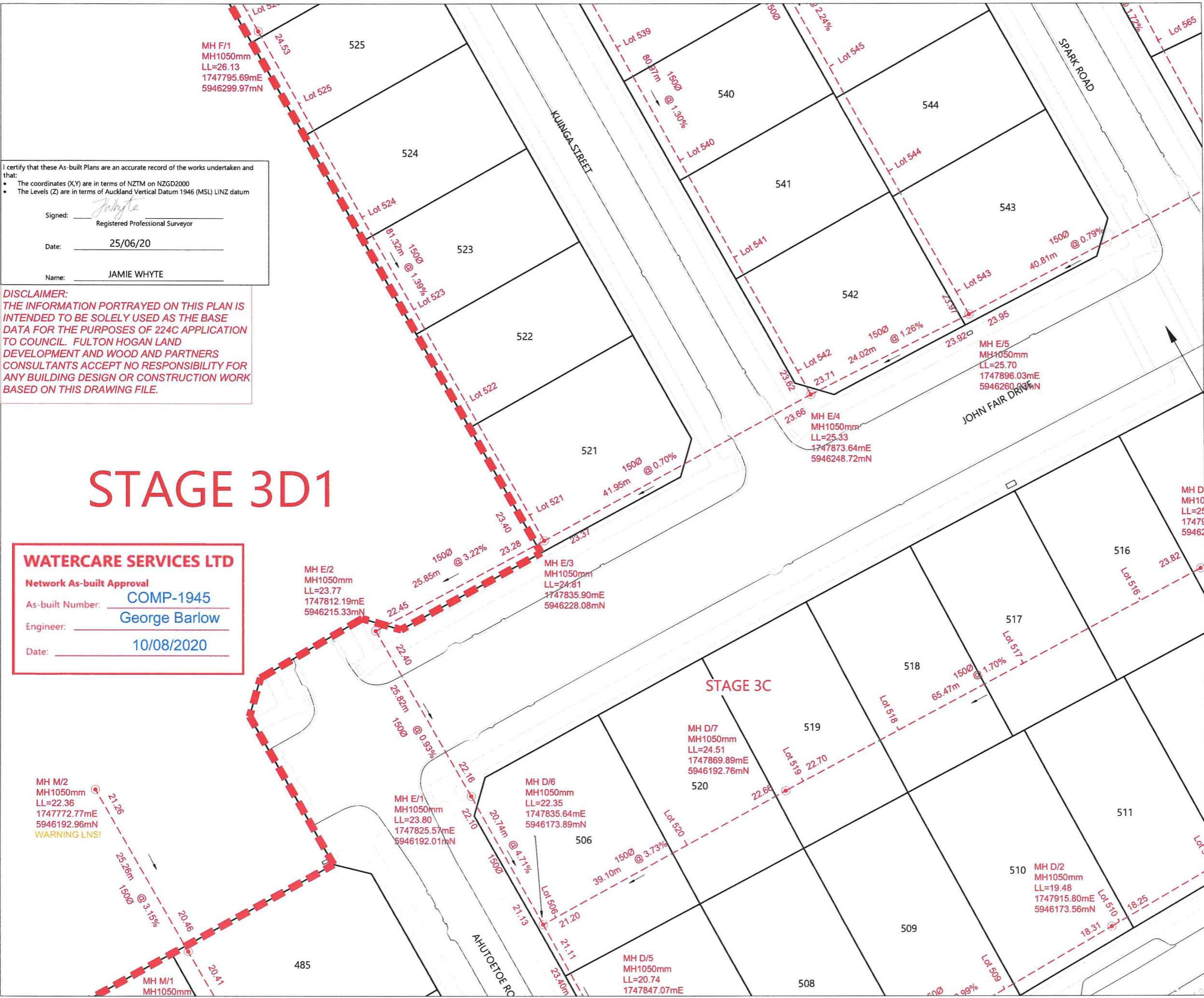
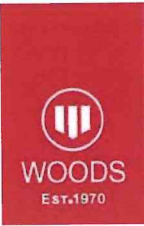

I certify that these As-built Plans are an accurate record of the works undertaken and that:

- The coordinates (X,Y) are in terms of NZTM on NZGD2000
- The Levels (Z) are in terms of Auckland Vertical Datum 1946 (MSL) LINZ datum

Signed: J Whyte
Registered Professional Surveyor

Date: 25/06/20

Name: JAMIE WHYTE

DISCLAIMER:
THE INFORMATION PORTRAYED ON THIS PLAN IS INTENDED TO BE SOLELY USED AS THE BASE DATA FOR THE PURPOSES OF 224C APPLICATION TO COUNCIL. FULTON HOGAN LAND DEVELOPMENT AND WOOD AND PARTNERS CONSULTANTS ACCEPT NO RESPONSIBILITY FOR ANY BUILDING DESIGN OR CONSTRUCTION WORK BASED ON THIS DRAWING FILE.

STAGE 3D1

WATERCARE SERVICES LTD
Network As-built Approval
As-built Number: COMP-1945
Engineer: George Barlow
Date: 10/08/2020

LEGEND

- NEW SANITARY SEWER MANHOLE
- NEW SANITARY SEWER
- EXISTING SANITARY SEWER
- LOT BOUNDARIES
- STAGE BOUNDARY
- UNCONFIRMED DATA
- EXISTING DATA ADJUSTED
- INVERT HAS DROP-PIPE STRUCTURE

- NOTES**
- ALL WORKS AND MATERIALS COMPLY WITH AUCKLAND COUNCIL & WATERCARE SERVICES LTD STANDARDS FOR ENGINEERING DESIGN AND CONSTRUCTION.
 - ALL SANITARY SEWER LINES ARE 150mmØ uPVC CLASS SN16 UNLESS STATED OTHERWISE.
 - ALL PIPE BEDDING COMPLIES WITH WATERCARE STANDARDS.
 - ALL PIPE CROSSINGS UNDER ROADS AND ACCESSWAYS HAVE BEEN HARDFILL BACKFILLED.
 - ALL PRIVATE LOT CONNECTIONS ARE 100mmØ
 - LOT BOUNDARIES ARE SUBJECT TO FINAL SURVEY.
 - ALL PIPE AND MH DIAMETERS ARE INTERNAL, AND SHOWN IN MILLIMETERS UNLESS OTHERWISE SPECIFIED.
 - ASBUILT DATA HAS BEEN SOURCED FROM A COMBINATION OF WOODS SURVEY MEASURED DATA AND CONTRACTOR RECEIVED DATA.

REVISION DETAILS		BY	DATE
1	ISSUED FOR INFORMATION	KR	25/06/20

SURVEYED	WOODS	WOODS Ltd LEVEL 1 BUILDING B 8 NUGENT STREET, GRAFTON AUCKLAND 1023 09 308 9229 WOODS.CO.NZ
DESIGNED	NM	
DRAWN	HP	
CHECKED	KR	
APPROVED	JW	

MILDALE
Counselling Lifestyle

MILDALE
STAGE 3C
WASTEWATER ASBUILT
OVERALL LAYOUT
SHEET 4 of 8

STATUS	ASBUILT	REV
SCALE	1 : 500 @ A3	1
COUNCIL	AUCKLAND COUNCIL	
DWG NO	P18-305-03C-403-AB	

DISCLAIMER:
 THE INFORMATION PORTRAYED ON THIS PLAN IS INTENDED TO BE SOLELY USED AS THE BASE DATA FOR THE PURPOSES OF 224C APPLICATION TO COUNCIL. FULTON HOGAN LAND DEVELOPMENT AND WOOD AND PARTNERS CONSULTANTS ACCEPT NO RESPONSIBILITY FOR ANY BUILDING DESIGN OR CONSTRUCTION WORK BASED ON THIS DRAWING FILE.

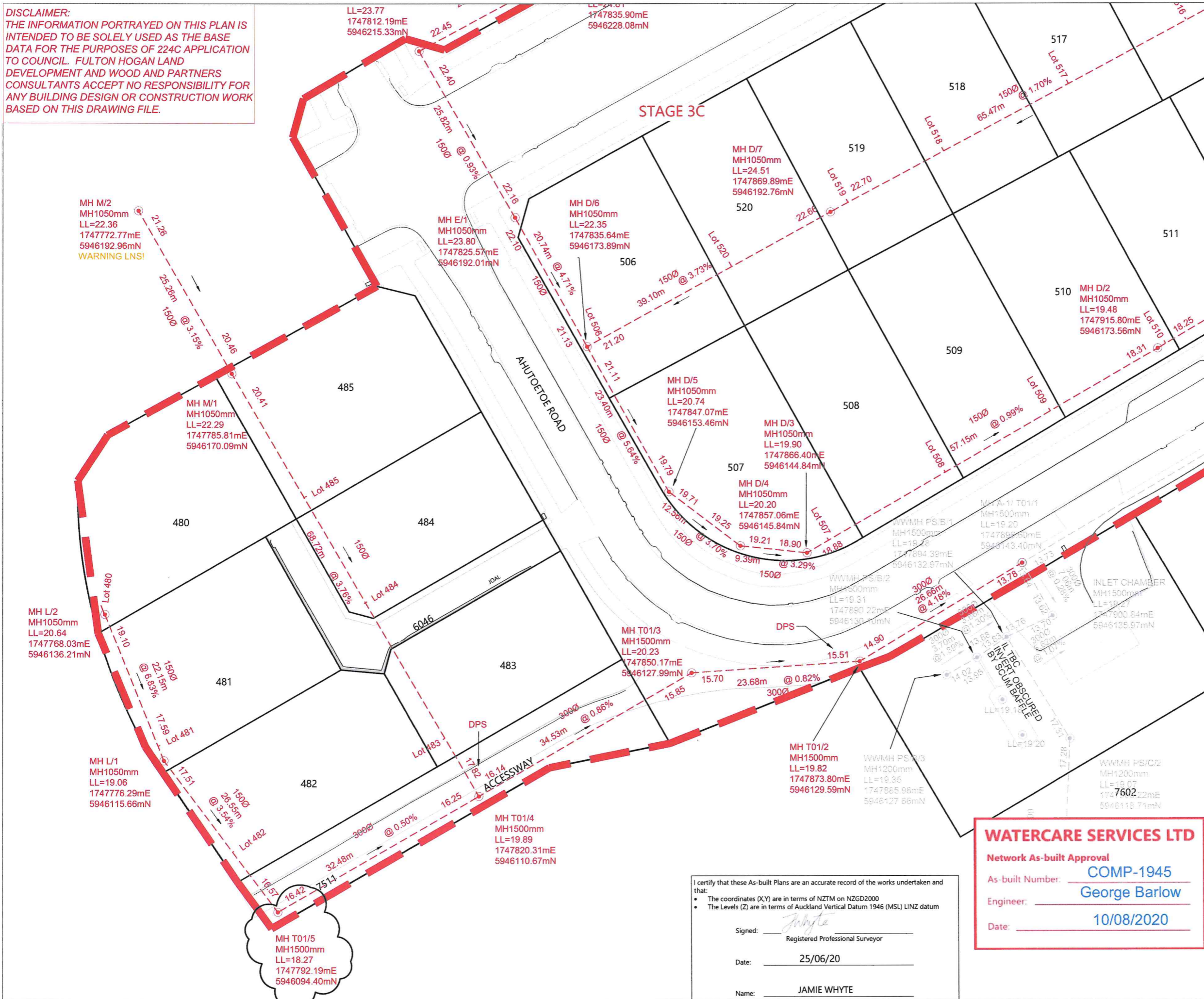

LEGEND

NEW SANITARY SEWER MANHOLE	●
NEW SANITARY SEWER	---
EXISTING SANITARY SEWER	---
LOT BOUNDARIES	---
STAGE BOUNDARY	---
UNCONFIRMED DATA	WARNING: LNS!!
EXISTING DATA ADJUSTED	LL= 23.74
INVERT HAS DROP-PIPE STRUCTURE	DPS

- NOTES**
1. ALL WORKS AND MATERIALS COMPLY WITH AUCKLAND COUNCIL & WATERCARE SERVICES LTD STANDARDS FOR ENGINEERING DESIGN AND CONSTRUCTION.
 2. ALL SANITARY SEWER LINES ARE 150mmØ uPVC CLASS SN16 UNLESS STATED OTHERWISE.
 3. ALL PIPE BEDDING COMPLIES WITH WATERCARE STANDARDS.
 4. ALL PIPE CROSSINGS UNDER ROADS AND ACCESSWAYS HAVE BEEN HARDFILL BACKFILLED.
 5. ALL PRIVATE LOT CONNECTIONS ARE 100mmØ
 6. LOT BOUNDARIES ARE SUBJECT TO FINAL SURVEY.
 7. ALL PIPE AND MH DIAMETERS ARE INTERNAL, AND SHOWN IN MILLIMETERS UNLESS OTHERWISE SPECIFIED.
 8. ASBUILT DATA HAS BEEN SOURCED FROM A COMBINATION OF WOODS SURVEY MEASURED DATA AND CONTRACTOR RECEIVED DATA.

REVISION DETAILS	BY	DATE
1 ISSUED FOR INFORMATION	KR	25/06/20
2 MH DIAMETER AMENDED	SK	05/08/20

SURVEYED	WOODS	WOODS Ltd LEVEL 1 BUILDING B 8 NUGENT STREET, GRAFTON AUCKLAND 1023
DESIGNED	NM	
DRAWN	HP	
CHECKED	KR	09 308 9229
APPROVED	JW	WOODS.CO.NZ

MILDALE
STAGE 3C
 WASTEWATER ASBUILT
 OVERALL LAYOUT
 SHEET 5 of 8

STATUS	ASBUILT	REV
SCALE	1 : 500 @ A3	2
COUNCIL	AUCKLAND COUNCIL	
DWG NO	P18-305-03C-404-AB	

WATERCARE SERVICES LTD
 Network As-built Approval
 As-built Number: **COMP-1945**
 Engineer: **George Barlow**
 Date: **10/08/2020**

I certify that these As-built Plans are an accurate record of the works undertaken and that:

- The coordinates (X,Y) are in terms of NZTM on NZGD2000
- The Levels (Z) are in terms of Auckland Vertical Datum 1946 (MSL) LINZ datum

Signed: J Whyte
 Registered Professional Surveyor
 Date: 25/06/20
 Name: JAMIE WHYTE

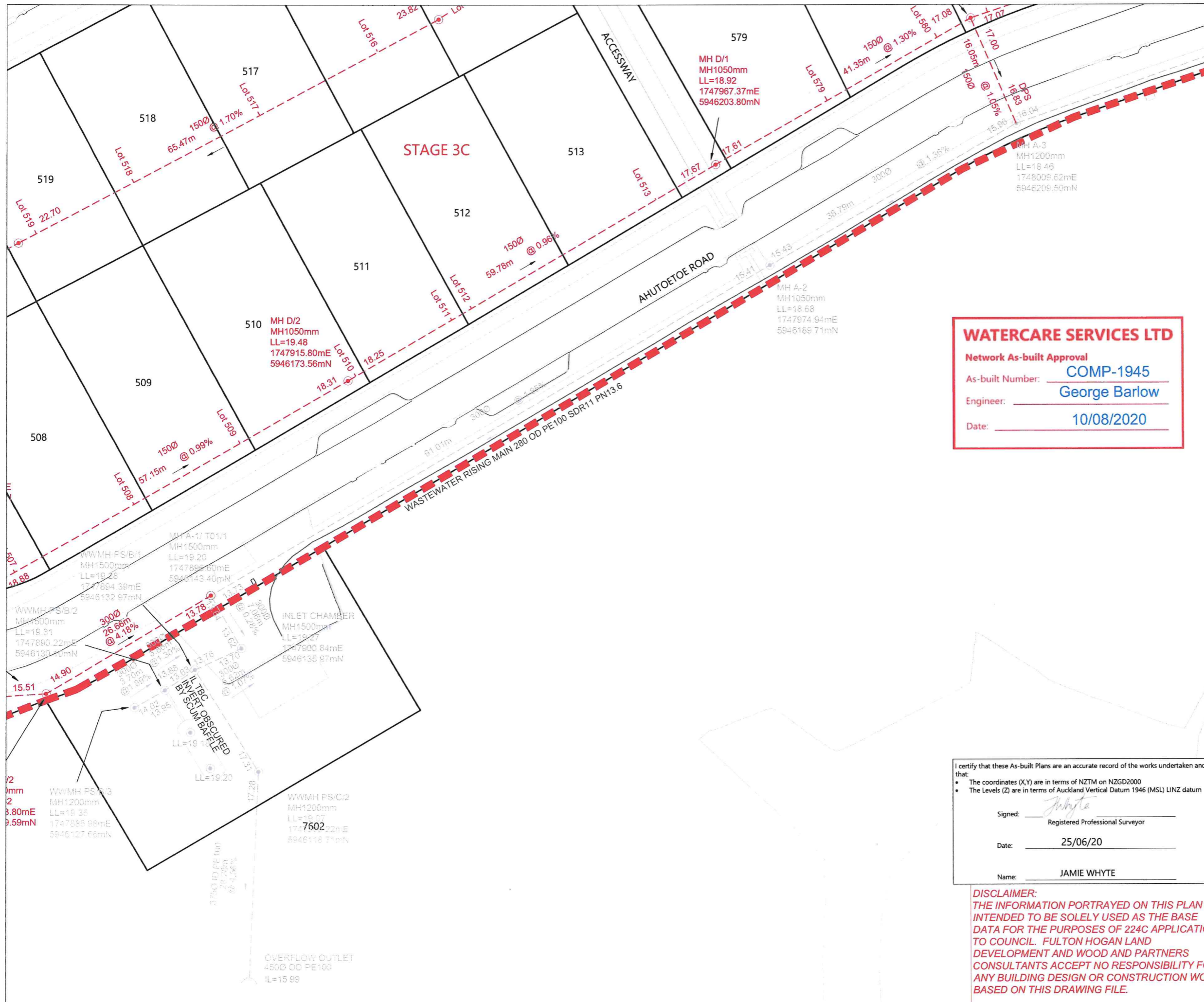

LEGEND

NEW SANITARY SEWER MANHOLE	
NEW SANITARY SEWER	
EXISTING SANITARY SEWER	
LOT BOUNDARIES	
STAGE BOUNDARY	
UNCONFIRMED DATA	WARNING: LNS!!
EXISTING DATA ADJUSTED	LL= 23.74
INVERT HAS DROP-PIPE STRUCTURE	

- NOTES**
- ALL WORKS AND MATERIALS COMPLY WITH AUCKLAND COUNCIL & WATERCARE SERVICES LTD STANDARDS FOR ENGINEERING DESIGN AND CONSTRUCTION.
 - ALL SANITARY SEWER LINES ARE 150mmØ uPVC CLASS SN16 UNLESS STATED OTHERWISE.
 - ALL PIPE BEDDING COMPLIES WITH WATERCARE STANDARDS.
 - ALL PIPE CROSSINGS UNDER ROADS AND ACCESSWAYS HAVE BEEN HARDFILL BACKFILLED.
 - ALL PRIVATE LOT CONNECTIONS ARE 100mmØ
 - LOT BOUNDARIES ARE SUBJECT TO FINAL SURVEY.
 - ALL PIPE AND MH DIAMETERS ARE INTERNAL, AND SHOWN IN MILLIMETERS UNLESS OTHERWISE SPECIFIED.
 - ASBUILT DATA HAS BEEN SOURCED FROM A COMBINATION OF WOODS SURVEY MEASURED DATA AND CONTRACTOR RECEIVED DATA.

WATERCARE SERVICES LTD
 Network As-built Approval
 As-built Number: COMP-1945
 Engineer: George Barlow
 Date: 10/08/2020

REVISION DETAILS	BY	DATE
1 ISSUED FOR INFORMATION	KR	25/06/20
2 A/3 DPS NOTE ADDED	SK	05/08/20

SURVEYED	WOODS	WOODS Ltd LEVEL 1 BUILDING B 8 NUGENT STREET, GRAFTON AUCKLAND 1023 09 308 9229 WOODS.CO.NZ
DESIGNED	NM	
DRAWN	HP	
CHECKED	KR	
APPROVED	JW	

MILLDALE
STAGE 3C
 WASTEWATER ASBUILT
 OVERALL LAYOUT
 SHEET 6 of 8

I certify that these As-built Plans are an accurate record of the works undertaken and that:

- The coordinates (X,Y) are in terms of NZTM on NZGD2000
- The Levels (Z) are in terms of Auckland Vertical Datum 1946 (MSL) LINZ datum

Signed: J Whyte
 Registered Professional Surveyor
 Date: 25/06/20
 Name: JAMIE WHYTE

DISCLAIMER:
 THE INFORMATION PORTRAYED ON THIS PLAN IS INTENDED TO BE SOLELY USED AS THE BASE DATA FOR THE PURPOSES OF 224C APPLICATION TO COUNCIL. FULTON HOGAN LAND DEVELOPMENT AND WOOD AND PARTNERS CONSULTANTS ACCEPT NO RESPONSIBILITY FOR ANY BUILDING DESIGN OR CONSTRUCTION WORK BASED ON THIS DRAWING FILE.

STATUS	ASBUILT	REV
SCALE	1 : 500 @ A3	2
COUNCIL	AUCKLAND COUNCIL	
DWG NO	P18-305-03C-405-AB	

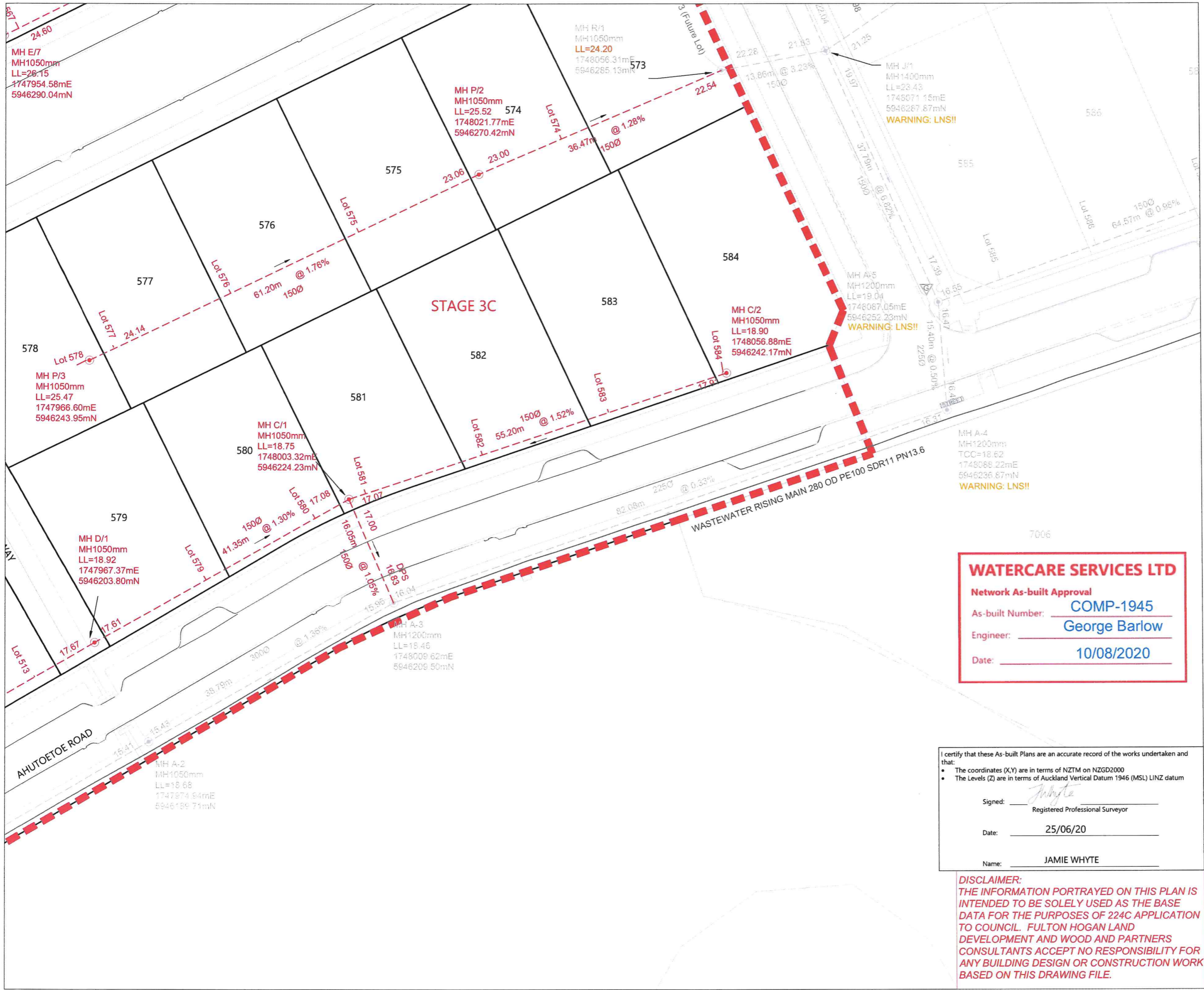

LEGEND

NEW SANITARY SEWER MANHOLE	
NEW SANITARY SEWER	
EXISTING SANITARY SEWER	
LOT BOUNDARIES	
STAGE BOUNDARY	
UNCONFIRMED DATA	WARNING: LNS!!
EXISTING DATA ADJUSTED	LL= 23.74
INVERT HAS DROP-PIPE STRUCTURE	DPS

- NOTES**
1. ALL WORKS AND MATERIALS COMPLY WITH AUCKLAND COUNCIL & WATERCARE SERVICES LTD STANDARDS FOR ENGINEERING DESIGN AND CONSTRUCTION.
 2. ALL SANITARY SEWER LINES ARE 150mmØ uPVC CLASS SN16 UNLESS STATED OTHERWISE.
 3. ALL PIPE BEDDING COMPLIES WITH WATERCARE STANDARDS.
 4. ALL PIPE CROSSINGS UNDER ROADS AND ACCESSWAYS HAVE BEEN HARDFILL BACKFILLED.
 5. ALL PRIVATE LOT CONNECTIONS ARE 100mmØ
 6. LOT BOUNDARIES ARE SUBJECT TO FINAL SURVEY.
 7. ALL PIPE AND MH DIAMETERS ARE INTERNAL, AND SHOWN IN MILLIMETERS UNLESS OTHERWISE SPECIFIED.
 8. ASBUILT DATA HAS BEEN SOURCED FROM A COMBINATION OF WOODS SURVEY MEASURED DATA AND CONTRACTOR RECEIVED DATA.

WATERCARE SERVICES LTD
 Network As-built Approval
 As-built Number: **COMP-1945**
 Engineer: **George Barlow**
 Date: **10/08/2020**

REVISION DETAILS	BY	DATE
1 ISSUED FOR INFORMATION	KR	25/06/20
2 DPS NOTE REVISED A/3, R/1	SK	05/08/20

SURVEYED	WOODS	WOODS Ltd LEVEL 1 BUILDING B 8 NUGENT STREET, GRAFTON AUCKLAND 1023 09 308 9229 WOODS.CO.NZ
DESIGNED	NM	
DRAWN	HP	
CHECKED	KR	
APPROVED	JW	

I certify that these As-built Plans are an accurate record of the works undertaken and that:

- The coordinates (X,Y) are in terms of NZTM on NZGD2000
- The Levels (Z) are in terms of Auckland Vertical Datum 1946 (MSL) LINZ datum

Signed: *J Whyte*
 Registered Professional Surveyor
 Date: 25/06/20
 Name: JAMIE WHYTE

DISCLAIMER:
 THE INFORMATION PORTRAYED ON THIS PLAN IS INTENDED TO BE SOLELY USED AS THE BASE DATA FOR THE PURPOSES OF 224C APPLICATION TO COUNCIL. FULTON HOGAN LAND DEVELOPMENT AND WOOD AND PARTNERS CONSULTANTS ACCEPT NO RESPONSIBILITY FOR ANY BUILDING DESIGN OR CONSTRUCTION WORK BASED ON THIS DRAWING FILE.



MILLDALE
STAGE 3C
 WASTEWATER ASBUILT
 OVERALL LAYOUT
 SHEET 7 of 8

STATUS	ASBUILT	REV
SCALE	1: 500 @ A3	2
COUNCIL	AUCKLAND COUNCIL	
DWG NO	P18-305-03C-406-AB	

DISCLAIMER:
 THE INFORMATION PORTRAYED ON THIS PLAN IS INTENDED TO BE SOLELY USED AS THE BASE DATA FOR THE PURPOSES OF 224C APPLICATION TO COUNCIL. FULTON HOGAN LAND DEVELOPMENT AND WOOD AND PARTNERS CONSULTANTS ACCEPT NO RESPONSIBILITY FOR ANY BUILDING DESIGN OR CONSTRUCTION WORK BASED ON THIS DRAWING FILE.

I certify that these As-built Plans are an accurate record of the works undertaken and that:

- The coordinates (X,Y) are in terms of NZTM on NZGD2000
- The Levels (Z) are in terms of Auckland Vertical Datum 1946 (MSL) LINZ datum

Signed: J Whyte
 Registered Professional Surveyor

Date: 25/06/20

Name: JAMIE WHYTE



WATERCARE SERVICES LTD
 Network As-built Approval
 As-built Number: COMP-1945
 Engineer: George Barlow
 Date: 10/08/2020

STAGE 3A

LEGEND

NEW SANITARY SEWER MANHOLE	
NEW SANITARY SEWER	
EXISTING SANITARY SEWER	
LOT BOUNDARIES	
STAGE BOUNDARY	
UNCONFIRMED DATA	WARNING: LNS!!
EXISTING DATA ADJUSTED	LL= 23.74
INVERT HAS DROP-PIPE STRUCTURE	DPS

- NOTES**
- ALL WORKS AND MATERIALS COMPLY WITH AUCKLAND COUNCIL & WATERCARE SERVICES LTD STANDARDS FOR ENGINEERING DESIGN AND CONSTRUCTION.
 - ALL SANITARY SEWER LINES ARE 150mmØ uPVC CLASS SN16 UNLESS STATED OTHERWISE.
 - ALL PIPE BEDDING COMPLIES WITH WATERCARE STANDARDS.
 - ALL PIPE CROSSINGS UNDER ROADS AND ACCESSWAYS HAVE BEEN HARDFILL BACKFILLED.
 - ALL PRIVATE LOT CONNECTIONS ARE 100mmØ
 - LOT BOUNDARIES ARE SUBJECT TO FINAL SURVEY.
 - ALL PIPE AND MH DIAMETERS ARE INTERNAL, AND SHOWN IN MILLIMETERS UNLESS OTHERWISE SPECIFIED.
 - ASBUILT DATA HAS BEEN SOURCED FROM A COMBINATION OF WOODS SURVEY MEASURED DATA AND CONTRACTOR RECEIVED DATA.

REVISION DETAILS	BY	DATE
1 ISSUED FOR INFORMATION	KR	25/06/20

SURVEYED	WOODS	WOODS Ltd LEVEL 1 BUILDING 8 8 NUGENT STREET, GRAFTON AUCKLAND 1023 09 308 9229 WOODS.CO.NZ
DESIGNED	NM	
DRAWN	HP	
CHECKED	KR	
APPROVED	JW	

MILLDALE
 Connecting Lifelines

**MILLDALE
 STAGE 3C
 WASTEWATER ASBUILT
 OVERALL LAYOUT
 SHEET 8 of 8**

STATUS	ASBUILT	REV
SCALE	1 : 500 @ A3	1
COUNCIL	AUCKLAND COUNCIL	
DWG NO	P18-305-03C-407-AB	

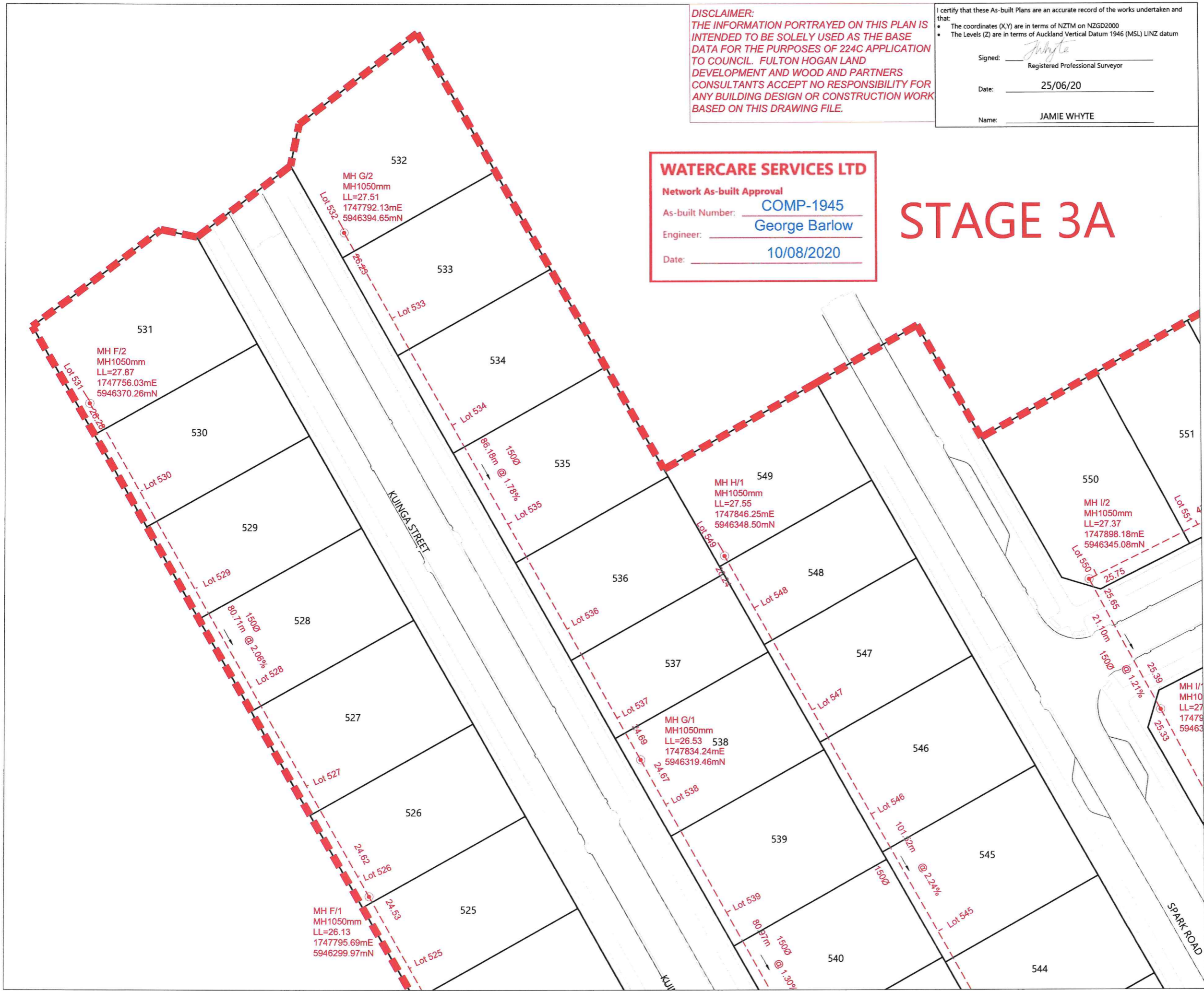



SCHEDULE OF COORDINATES

NAME	EASTING	NORTHING
WATERMAIN LOT CONNECTION VALVES		
Lot 480	1747794.18	5946149.77
Lot 481	1747800.19	5946128.41
Lot 482	1747800.52	5946127.48
Lot 483	1747832.65	5946144.90
Lot 484	1747821.48	5946164.62
Lot 485	1747821.22	5946165.29
Lot 506	1747842.86	5946203.40
Lot 507	1747874.25	5946146.47
Lot 508	1747888.21	5946154.78
Lot 509	1747889.00	5946155.18
Lot 510	1747918.70	5946172.76
Lot 511	1747919.68	5946173.23
Lot 512	1747946.26	5946189.01
Lot 513	1747947.32	5946189.58
Lot 515	1747917.58	5946243.24
Lot 516	1747916.58	5946242.73
Lot 517	1747888.14	5946227.54
Lot 518	1747886.93	5946227.15
Lot 519	1747858.89	5946211.84
Lot 520	1747857.71	5946211.39
Lot 521	1747849.07	5946257.12
Lot 522	1747848.62	5946257.77
Lot 523	1747834.01	5946283.32
Lot 524	1747833.61	5946284.13
Lot 525	1747818.37	5946311.03
Lot 526	1747817.87	5946312.09
Lot 527	1747802.49	5946338.92
Lot 528	1747802.01	5946339.80
Lot 529	1747787.87	5946365.34
Lot 530	1747787.12	5946366.68
Lot 531	1747771.75	5946393.74

SCHEDULE OF COORDINATES

NAME	EASTING	NORTHING
FIRE HYDRANTS		
Lot 533	1747799.05	5946377.48
Lot 534	1747799.85	5946376.20
Lot 535	1747815.71	5946347.78
Lot 536	1747816.31	5946346.63
Lot 537	1747829.94	5946322.54
Lot 538	1747830.33	5946321.77
Lot 539	1747846.74	5946292.72
Lot 540	1747847.01	5946292.28
Lot 541	1747862.42	5946265.02
Lot 542	1747863.00	5946264.32
Lot 543	1747907.53	5946288.68
Lot 544	1747906.91	5946289.57
Lot 545	1747890.71	5946318.31
PEET VALVES		
Lot 546	1747890.35	5946319.17
Lot 547	1747873.94	5946347.72
Lot 548	1747873.73	5946348.55
Lot 549	1747867.37	5946359.75
Lot 550	1747912.33	5946349.67
Lot 551	1747913.03	5946350.04
Lot 552	1747939.71	5946363.49
Lot 553	1747940.56	5946363.85
SLUICE VALVES		
Lot 554	1747966.97	5946376.63
Lot 555	1747967.72	5946377.16
Lot 556	1747995.11	5946389.86
Lot 557	1747995.99	5946390.28
Lot 558	1748002.67	5946376.04
Lot 559	1748001.94	5946375.72
Lot 560	1747974.21	5946362.30
Lot 561	1747973.19	5946362.07
Lot 562	1747942.96	5946346.51
Lot 563	1747941.93	5946346.30
Lot 564	1747927.82	5946339.48
Lot 565	1747921.38	5946296.28
Lot 566	1747921.92	5946295.53
Lot 567	1747968.05	5946294.78
Lot 568	1747968.96	5946295.40
Lot 569	1747997.98	5946309.56
Lot 570	1747998.60	5946309.91
Lot 571	1748026.42	5946323.32
Lot 572	1748027.51	5946323.93
Lot 573	1748027.45	5946298.52
Lot 574	1748026.49	5946297.97
Lot 575	1747993.31	5946281.84
Lot 576	1747992.31	5946281.22
Lot 577	1747959.33	5946264.84
Lot 578	1747958.16	5946264.38
Lot 579	1747986.25	5946212.75
Lot 580	1747986.78	5946213.00
Lot 581	1748019.55	5946227.95
Lot 582	1748020.20	5946228.19
Lot 583	1748055.54	5946239.96
Lot 584	1748056.38	5946240.41
Lot 585	1747876.33	5946131.72
Lot 586	1747877.16	5946132.07

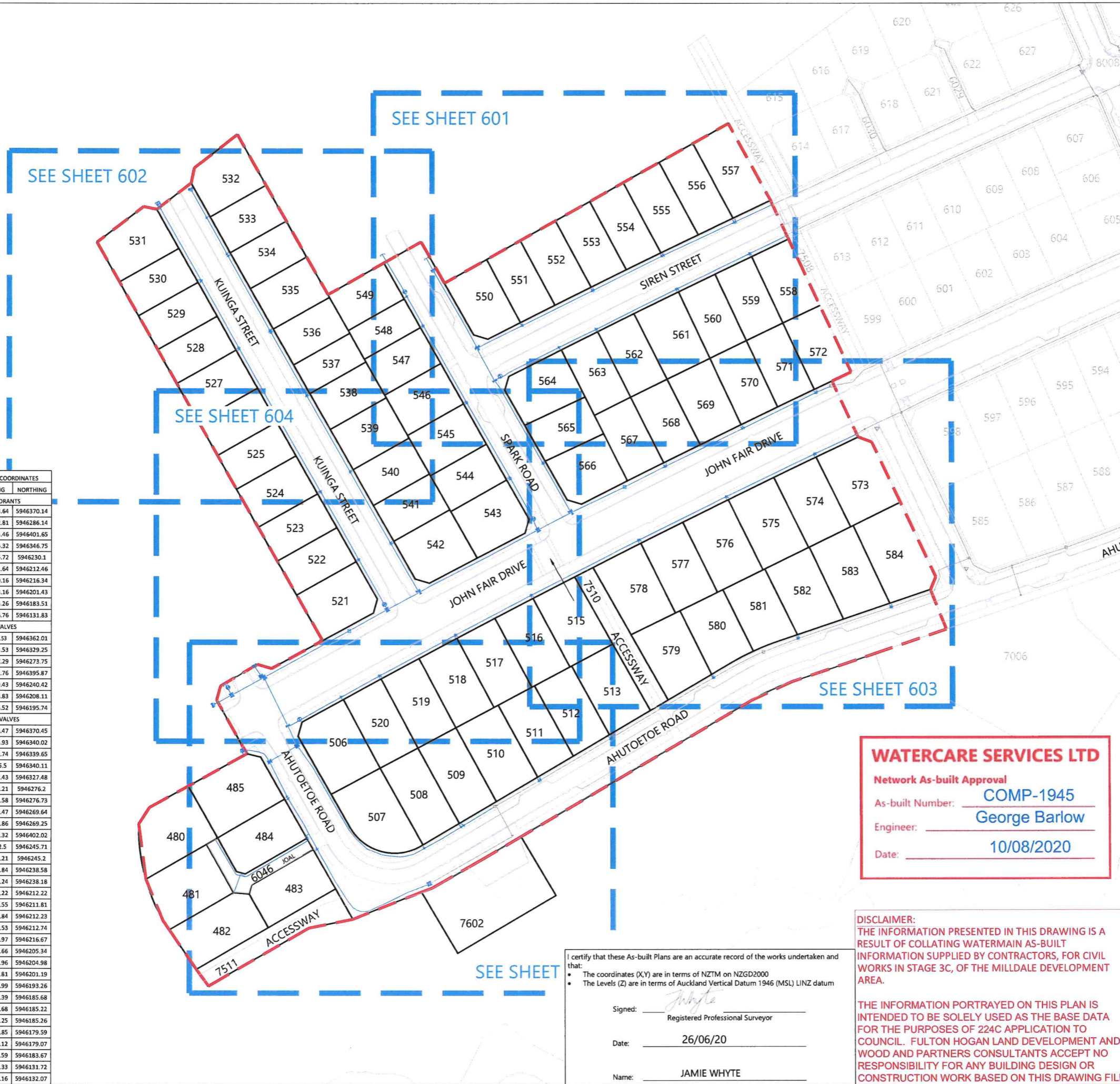

- NOTES**
1. ALL WORK AND MATERIALS COMPLIES WITH AC STANDARD FOR ENGINEERING DESIGN AND CONSTRUCTION.
 2. PIPE BEDDING COMPLIES WITH AC STD DETAIL DRAWING 18000 SHEET 4.4 UNLESS OTHERWISE NOTED.
 3. WATERMANS ARE AN AVERAGE 0.6m BELOW GROUND IN BERMS AND 0.9m BELOW GROUND UNDER ROADS. HARDFILL BACKFILLED BENEATH ROAD CROSSINGS.
 4. PIPE SIZES SHOWN ARE EXTERNAL DIAMETER.
 5. LOT BOUNDARIES ARE SUBJECT TO FINAL SURVEY.
 6. ASBUILT DATA HAS BEEN SOURCED FROM A COMBINATION OF WOODS SURVEY MEASURED DATA AND CONTRACTOR RECEIVED DATA.

LEGEND

EXISTING WATERMAIN	—
HIGH PESSURE WATERMAIN	—
SLUICE VALVE	⊥
PEET VALVE	⊥
FIRE HYDRANT	⊥
BLANK CAP	⊥
REDUCER	⊥
TAPPING BANDS	⊥
STAGE BOUNDARY	—

REVISION DETAILS

NO	DESCRIPTION	BY	DATE
1	ISSUED FOR INFORMATION	KR	25/06/20

SURVEYED	WOODS	WOODS Ltd LEVEL 1 BUILDING B 8 NUGENT STREET, GRAFTON AUCKLAND 1023 09 308 9229 WOODS.CO.NZ
DESIGNED	NM	
DRAWN	HP	
CHECKED	EY	
APPROVED	JW	

WATERCARE SERVICES LTD

Network As-built Approval

As-built Number: COMP-1945

Engineer: George Barlow

Date: 10/08/2020

DISCLAIMER:
THE INFORMATION PRESENTED IN THIS DRAWING IS A RESULT OF COLLATING WATERMAIN AS-BUILT INFORMATION SUPPLIED BY CONTRACTORS, FOR CIVIL WORKS IN STAGE 3C, OF THE MILLDALE DEVELOPMENT AREA.

THE INFORMATION PORTRAYED ON THIS PLAN IS INTENDED TO BE SOLELY USED AS THE BASE DATA FOR THE PURPOSES OF 224C APPLICATION TO COUNCIL. FULTON HOGAN LAND DEVELOPMENT AND WOOD AND PARTNERS CONSULTANTS ACCEPT NO RESPONSIBILITY FOR ANY BUILDING DESIGN OR CONSTRUCTION WORK BASED ON THIS DRAWING FILE.

I certify that these As-built Plans are an accurate record of the works undertaken and that:

- The coordinates (X,Y) are in terms of NZTM on NZGD2000
- The Levels (Z) are in terms of Auckland Vertical Datum 1946 (MSL) LINZ datum

Signed: J Whyte
Registered Professional Surveyor

Date: 26/06/20

Name: JAMIE WHYTE

**MILLDALE
STAGE 3C**

**WATERMAIN ASBUILT
LAYOUT PLAN
SHEET 1 of 6**

STATUS	AS-BUILT	REV
SCALE	1 : 1500 @ A3	1
COUNCIL	AUCKLAND COUNCIL	
DWG NO	P18-305-03C-600-AB	

DISCLAIMER:
 THE INFORMATION PRESENTED IN THIS DRAWING IS A RESULT OF COLLATING WATERMAIN AS-BUILT INFORMATION SUPPLIED BY CONTRACTORS, FOR CIVIL WORKS IN STAGE 3C, OF THE MILLDALE DEVELOPMENT AREA.

THE INFORMATION PORTRAYED ON THIS PLAN IS INTENDED TO BE SOLELY USED AS THE BASE DATA FOR THE PURPOSES OF 224C APPLICATION TO COUNCIL. FULTON HOGAN LAND DEVELOPMENT AND WOOD AND PARTNERS CONSULTANTS ACCEPT NO RESPONSIBILITY FOR ANY BUILDING DESIGN OR CONSTRUCTION WORK BASED ON THIS DRAWING FILE.

I certify that these As-built Plans are an accurate record of the works undertaken and that:

- The coordinates (X,Y) are in terms of NZTM on NZGD2000
- The Levels (Z) are in terms of Auckland Vertical Datum 1946 (MSL) LINZ datum

Signed: J Whyte
 Registered Professional Surveyor

Date: 26/06/20

Name: JAMIE WHYTE

WATERCARE SERVICES LTD

Network As-built Approval
 As-built Number: COMP-1945
 Engineer: George Barlow
 Date: 10/08/2020

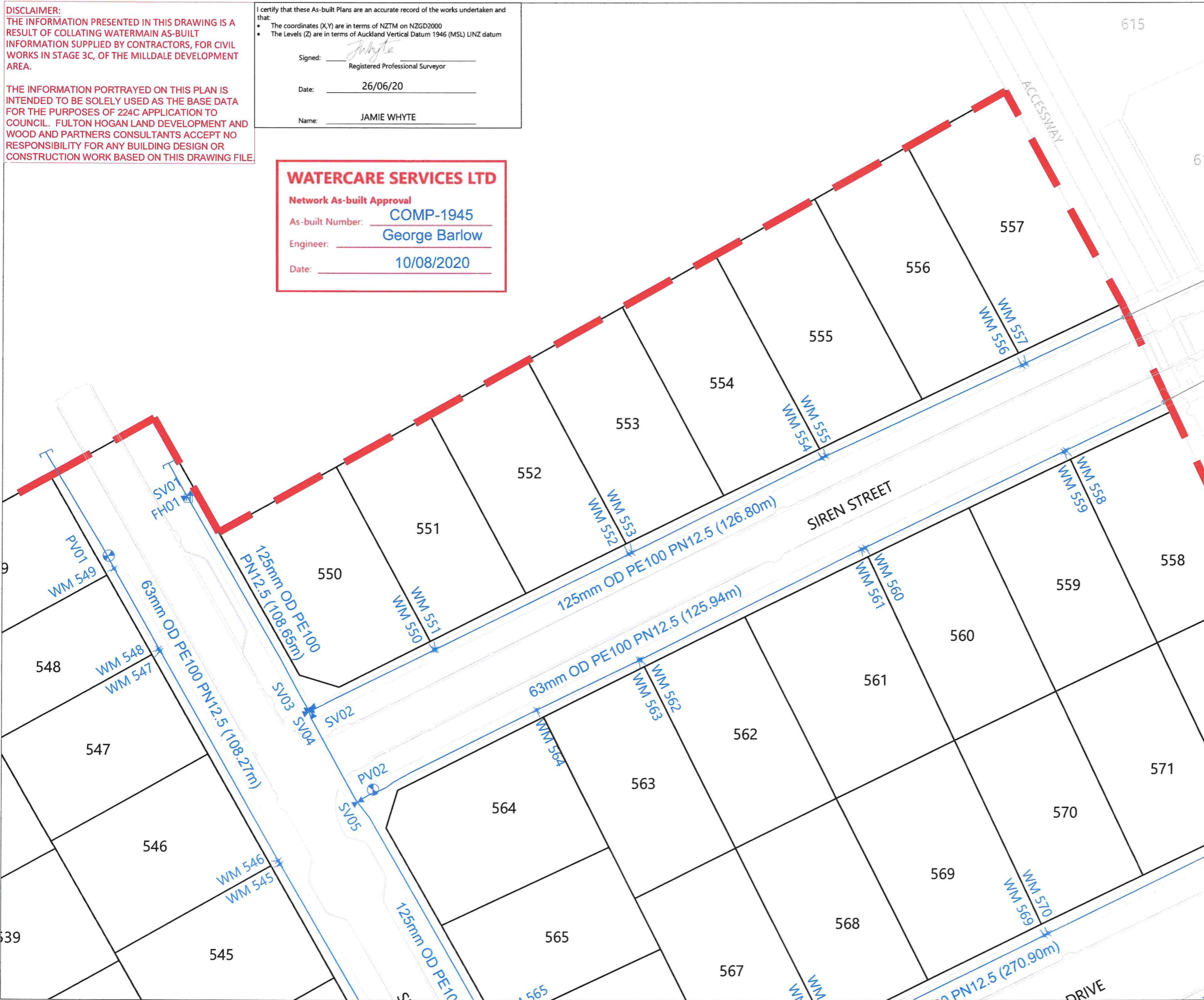

- NOTES**
- ALL WORK AND MATERIALS COMPLIES WITH AC STANDARD FOR ENGINEERING DESIGN AND CONSTRUCTION.
 - PIPE BEDDING COMPLIES WITH AC STD DETAIL DRAWING 18000 SHEET 4.4 UNLESS OTHERWISE NOTED.
 - WATERMANS ARE AN AVERAGE 0.6m BELOW GROUND IN BERMS AND 0.9m BELOW GROUND UNDER ROADS. HARDFILL BACKFILLED BENEATH ROAD CROSSINGS.
 - PIPE SIZES SHOWN ARE EXTERNAL DIAMETER.
 - LOT BOUNDARIES ARE SUBJECT TO FINAL SURVEY.
 - ASBUILT DATA HAS BEEN SOURCED FROM A COMBINATION OF WOODS SURVEY MEASURED DATA AND CONTRACTOR RECEIVED DATA.

LEGEND

- EXISTING WATERMAIN
- HIGH PESSURE WATERMAIN
- SLUICE VALVE
- PEET VALVE
- FIRE HYDRANT
- BLANK CAP
- REDUCER
- TAPPING BANDS
- STAGE BOUNDARY

REVISION DETAILS	BY	DATE
1 ISSUED FOR INFORMATION	KR	25/06/20

SURVEYED	WOODS	WOODS Ltd LEVEL 1 BUILDING B 8 NUGENT STREET, GRAFTON AUCKLAND 1023
DESIGNED	NM	
DRAWN	HP	
CHECKED	EY	09 308 9229
APPROVED	JW	WOODS.CO.NZ

MILLDALE
 Consulting & Design

MILLDALE
 STAGE 3C

WATERMAIN ASBUILT
 ASBUILT PLAN
 SHEET 2 of 6

STATUS	AS-BUILT	REV
SCALE	1 : 500 @ A3	1
COUNCIL	AUCKLAND COUNCIL	
DWG NO	P18-305-03C-601-AB	

I certify that these As-built Plans are an accurate record of the works undertaken and that:

- The coordinates (X,Y) are in terms of NZTM on NZGD2000
- The Levels (Z) are in terms of Auckland Vertical Datum 1946 (MSL) LINZ datum

Signed: J Whyte
Registered Professional Surveyor

Date: 26/06/20

Name: JAMIE WHYTE



- NOTES**
- ALL WORK AND MATERIALS COMPLIES WITH AC STANDARD FOR ENGINEERING DESIGN AND CONSTRUCTION.
 - PIPE BEDDING COMPLIES WITH AC STD DETAIL DRAWING 18000 SHEET 4.4 UNLESS OTHERWISE NOTED.
 - WATERMANS ARE AN AVERAGE 0.6m BELOW GROUND IN BERMS AND 0.9m BELOW GROUND UNDER ROADS. HARDFILL BACKFILLED BENEATH ROAD CROSSINGS.
 - PIPE SIZES SHOWN ARE EXTERNAL DIAMETER.
 - LOT BOUNDARIES ARE SUBJECT TO FINAL SURVEY.
 - ASBUILT DATA HAS BEEN SOURCED FROM A COMBINATION OF WOODS SURVEY MEASURED DATA AND CONTRACTOR RECEIVED DATA.

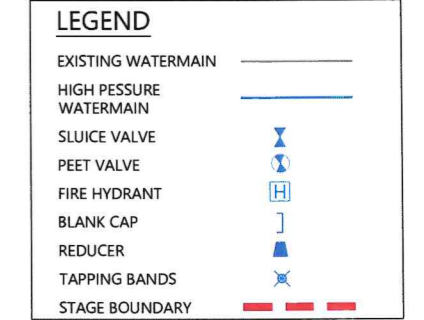

WATERCARE SERVICES LTD
Network As-built Approval
 As-built Number: COMP-1945
 Engineer: George Barlow
 Date: 10/08/2020

REVISION DETAILS	BY	DATE
1 ISSUED FOR INFORMATION	KR	25/06/20

SURVEYED	WOODS	WOODS Ltd
DESIGNED	NM	LEVEL 1 BUILDING B 8 NUGENT STREET, GRAFTON AUCKLAND 1023
DRAWN	HP	09 308 9229
CHECKED	EY	
APPROVED	JW	WOODS.CO.NZ

MILLDALE
 Geospatial Solutions

MILLDALE
STAGE 3C
 WATERMAIN ASBUILT
 ASBUILT PLAN
 SHEET 3 of 6

STATUS	AS-BUILT	REV
SCALE	1 : 500 @ A3	1
COUNCIL	AUCKLAND COUNCIL	
DWG NO	P18-305-03C-602-AB	

DISCLAIMER:
 THE INFORMATION PRESENTED IN THIS DRAWING IS A RESULT OF COLLATING WATERMAIN AS-BUILT INFORMATION SUPPLIED BY CONTRACTORS, FOR CIVIL WORKS IN STAGE 3C, OF THE MILLDALE DEVELOPMENT AREA.

THE INFORMATION PORTRAYED ON THIS PLAN IS INTENDED TO BE SOLELY USED AS THE BASE DATA FOR THE PURPOSES OF 224C APPLICATION TO COUNCIL. FULTON HOGAN LAND DEVELOPMENT AND WOOD AND PARTNERS CONSULTANTS ACCEPT NO RESPONSIBILITY FOR ANY BUILDING DESIGN OR CONSTRUCTION WORK BASED ON THIS DRAWING FILE.

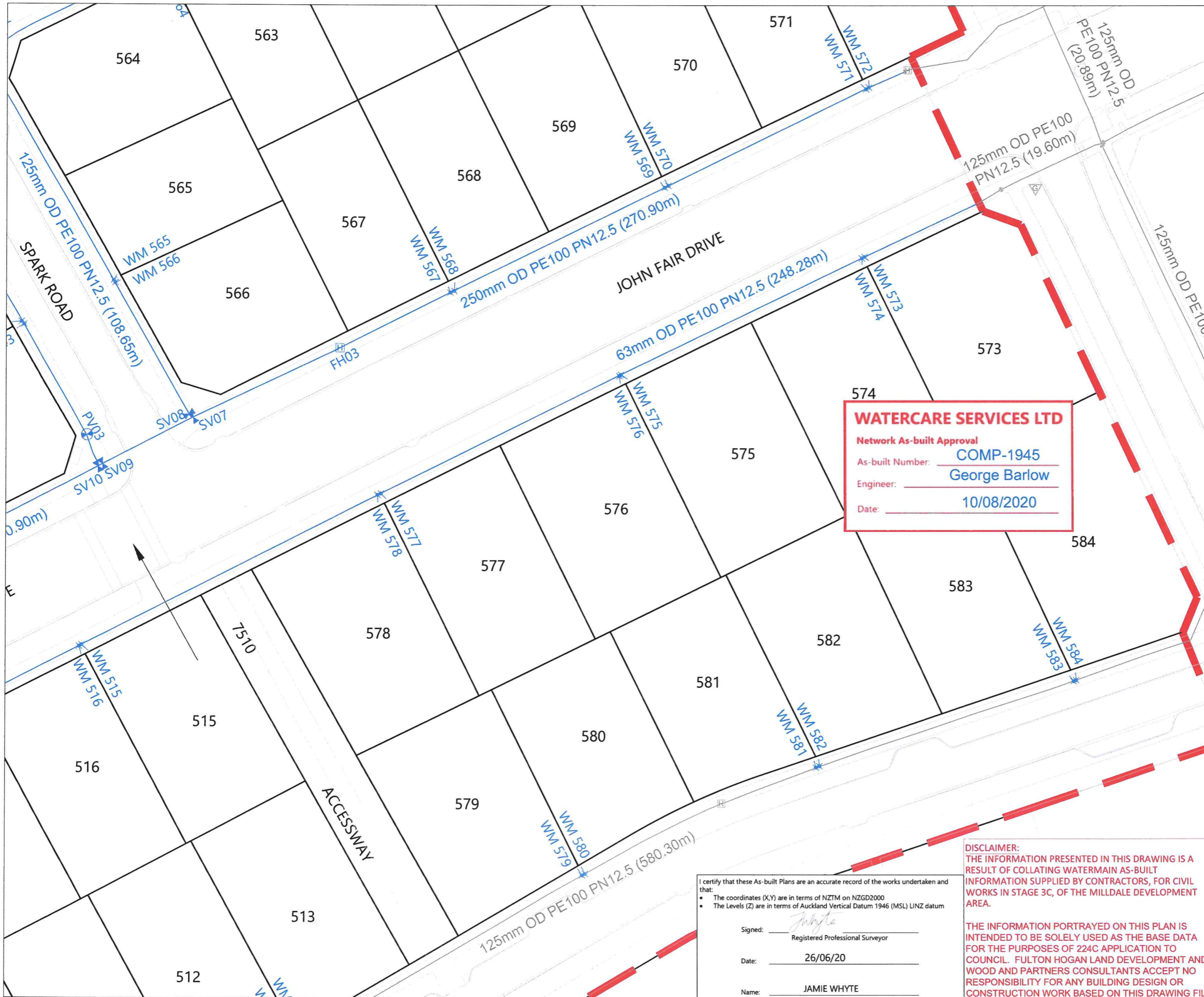

- NOTES**
1. ALL WORK AND MATERIALS COMPLIES WITH AC STANDARD FOR ENGINEERING DESIGN AND CONSTRUCTION.
 2. PIPE BEDDING COMPLIES WITH AC STD DETAIL DRAWING 18000 SHEET 4.4 UNLESS OTHERWISE NOTED.
 3. WATERMANS ARE AN AVERAGE 0.6m BELOW GROUND IN BERMS AND 0.9m BELOW GROUND UNDER ROADS. HARDFILL BACKFILLED BENEATH ROAD CROSSINGS.
 4. PIPE SIZES SHOWN ARE EXTERNAL DIAMETER.
 5. LOT BOUNDARIES ARE SUBJECT TO FINAL SURVEY.
 6. ASBUILT DATA HAS BEEN SOURCED FROM A COMBINATION OF WOODS SURVEY MEASURED DATA AND CONTRACTOR RECEIVED DATA.

WATERCARE SERVICES LTD
 Network As-built Approval
 As-built Number: COMP-1945
 Engineer: George Barlow
 Date: 10/08/2020

LEGEND

EXISTING WATERMAIN	—
HIGH PESSURE WATERMAIN	—
SLUICE VALVE	
PEET VALVE	
FIRE HYDRANT	
BLANK CAP	
REDUCER	
TAPPING BANDS	
STAGE BOUNDARY	

REVISION DETAILS	BY	DATE
1 ISSUED FOR INFORMATION	KR	25/06/20

SURVEYED	WOODS	WOODS Ltd LEVEL 1 BUILDING B 8 NUGENT STREET, GRAFTON AUCKLAND 1023 09 308 9229 WOODS.CO.NZ
DESIGNED	NM	
DRAWN	HP	
CHECKED	EY	
APPROVED	JW	



MILLDALE
 STAGE 3C

WATERMAIN ASBUILT
 ASBUILT PLAN
 SHEET 4 of 6

I certify that these As-built Plans are an accurate record of the works undertaken and that:

- The coordinates (X,Y) are in terms of NZTM on NZGD2000
- The Levels (Z) are in terms of Auckland Vertical Datum 1946 (MSL) LINZ datum

Signed: J Whyte
 Registered Professional Surveyor
 Date: 26/06/20
 Name: JAMIE WHYTE

DISCLAIMER:
 THE INFORMATION PRESENTED IN THIS DRAWING IS A RESULT OF COLLATING WATERMAIN AS-BUILT INFORMATION SUPPLIED BY CONTRACTORS, FOR CIVIL WORKS IN STAGE 3C, OF THE MILLDALE DEVELOPMENT AREA.

THE INFORMATION PORTRAYED ON THIS PLAN IS INTENDED TO BE SOLELY USED AS THE BASE DATA FOR THE PURPOSES OF 224C APPLICATION TO COUNCIL. FULTON HOGAN LAND DEVELOPMENT AND WOOD AND PARTNERS CONSULTANTS ACCEPT NO RESPONSIBILITY FOR ANY BUILDING DESIGN OR CONSTRUCTION WORK BASED ON THIS DRAWING FILE

STATUS	AS-BUILT	REV
SCALE	1 : 500 @ A3	1
COUNCIL	AUCKLAND COUNCIL	
DWG NO	P18-305-03C-603-AB	



WATERCARE SERVICES LTD
 Network As-built Approval
 As-built Number: COMP-1945
 Engineer: George Barlow
 Date: 10/08/2020

DISCLAIMER:
 THE INFORMATION PRESENTED IN THIS DRAWING IS A RESULT OF COLLATING WATERMAIN AS-BUILT INFORMATION SUPPLIED BY CONTRACTORS, FOR CIVIL WORKS IN STAGE 3C, OF THE MILLDALE DEVELOPMENT AREA.

THE INFORMATION PORTRAYED ON THIS PLAN IS INTENDED TO BE SOLELY USED AS THE BASE DATA FOR THE PURPOSES OF 224C APPLICATION TO COUNCIL. FULTON HOGAN LAND DEVELOPMENT AND WOOD AND PARTNERS CONSULTANTS ACCEPT NO RESPONSIBILITY FOR ANY BUILDING DESIGN OR CONSTRUCTION WORK BASED ON THIS DRAWING FILE.

I certify that these As-built Plans are an accurate record of the works undertaken and that:

- The coordinates (X,Y) are in terms of NZTM on NZGD2000
- The Levels (Z) are in terms of Auckland Vertical Datum 1946 (MSL) LINZ datum

Signed: J Whyte
 Registered Professional Surveyor
 Date: 26/06/20
 Name: JAMIE WHYTE

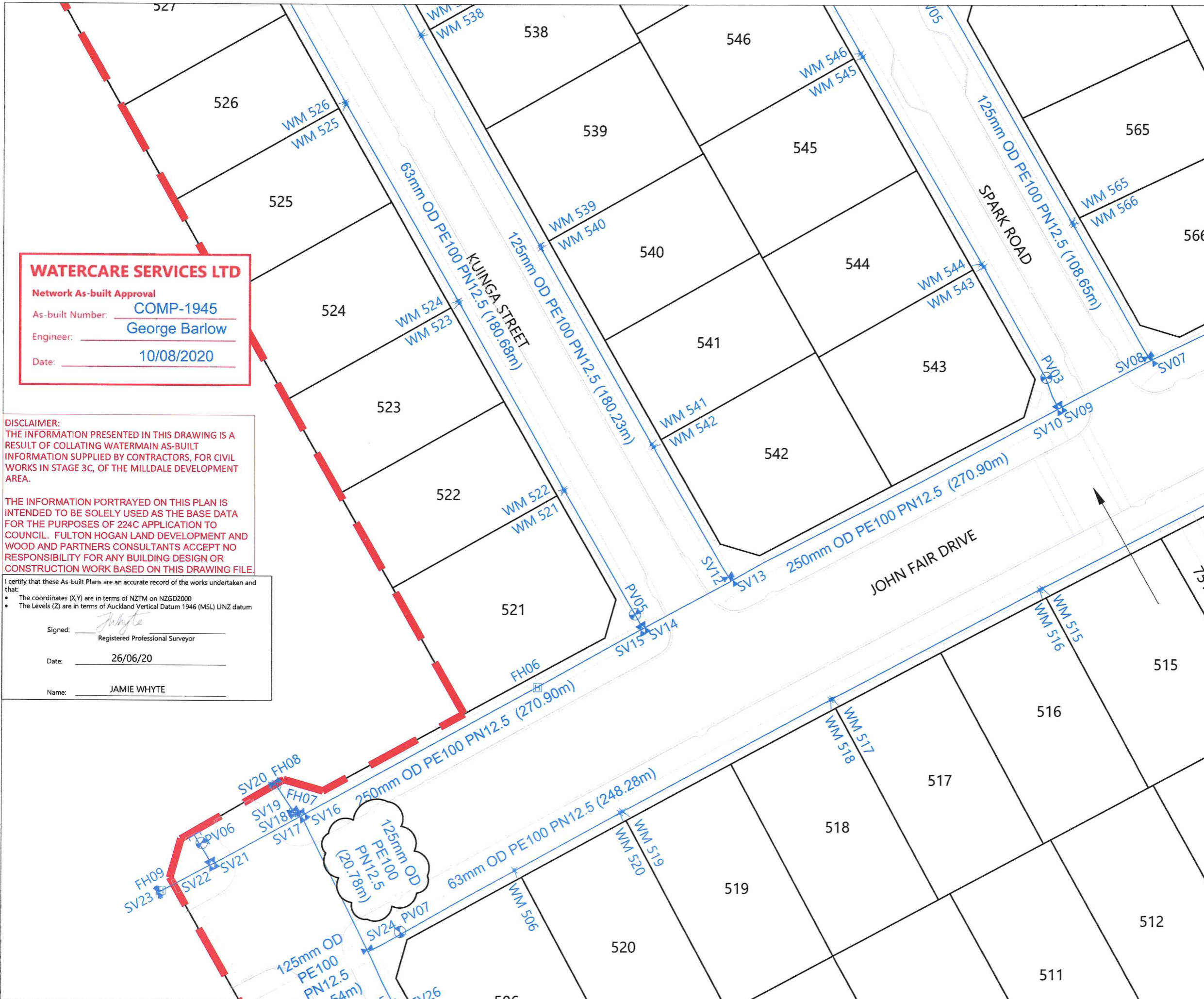

- NOTES**
- ALL WORK AND MATERIALS COMPLIES WITH AC STANDARD FOR ENGINEERING DESIGN AND CONSTRUCTION.
 - PIPE BEDDING COMPLIES WITH AC STD DETAIL DRAWING 18000 SHEET 4.4 UNLESS OTHERWISE NOTED.
 - WATERMANS ARE AN AVERAGE 0.6m BELOW GROUND IN BERMS AND 0.9m BELOW GROUND UNDER ROADS. HARDFILL BACKFILLED BENEATH ROAD CROSSINGS.
 - PIPE SIZES SHOWN ARE EXTERNAL DIAMETER.
 - LOT BOUNDARIES ARE SUBJECT TO FINAL SURVEY.
 - ASBUILT DATA HAS BEEN SOURCED FROM A COMBINATION OF WOODS SURVEY MEASURED DATA AND CONTRACTOR RECEIVED DATA.

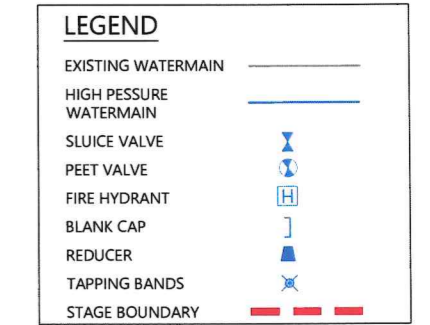

REVISION DETAILS	BY	DATE
1 ISSUED FOR INFORMATION	KR	25/06/20
2 WATERMAIN SIZE AMENDED	SK	05/08/20

SURVEYED	WOODS	WOODS Ltd LEVEL 1 BUILDING B 8 NUGENT STREET, GRAFTON AUCKLAND 1023
DESIGNED	NM	
DRAWN	HP	
CHECKED	EY	09 308 9229
APPROVED	JW	WOODS.CO.NZ



MILLDALE
 STAGE 3C
 WATERMAIN ASBUILT
 ASBUILT PLAN
 SHEET 5 of 6

STATUS	AS-BUILT	REV
SCALE	1 : 500 @ A3	2
COUNCIL	AUCKLAND COUNCIL	
DWG NO	P18-305-03C-604-AB	

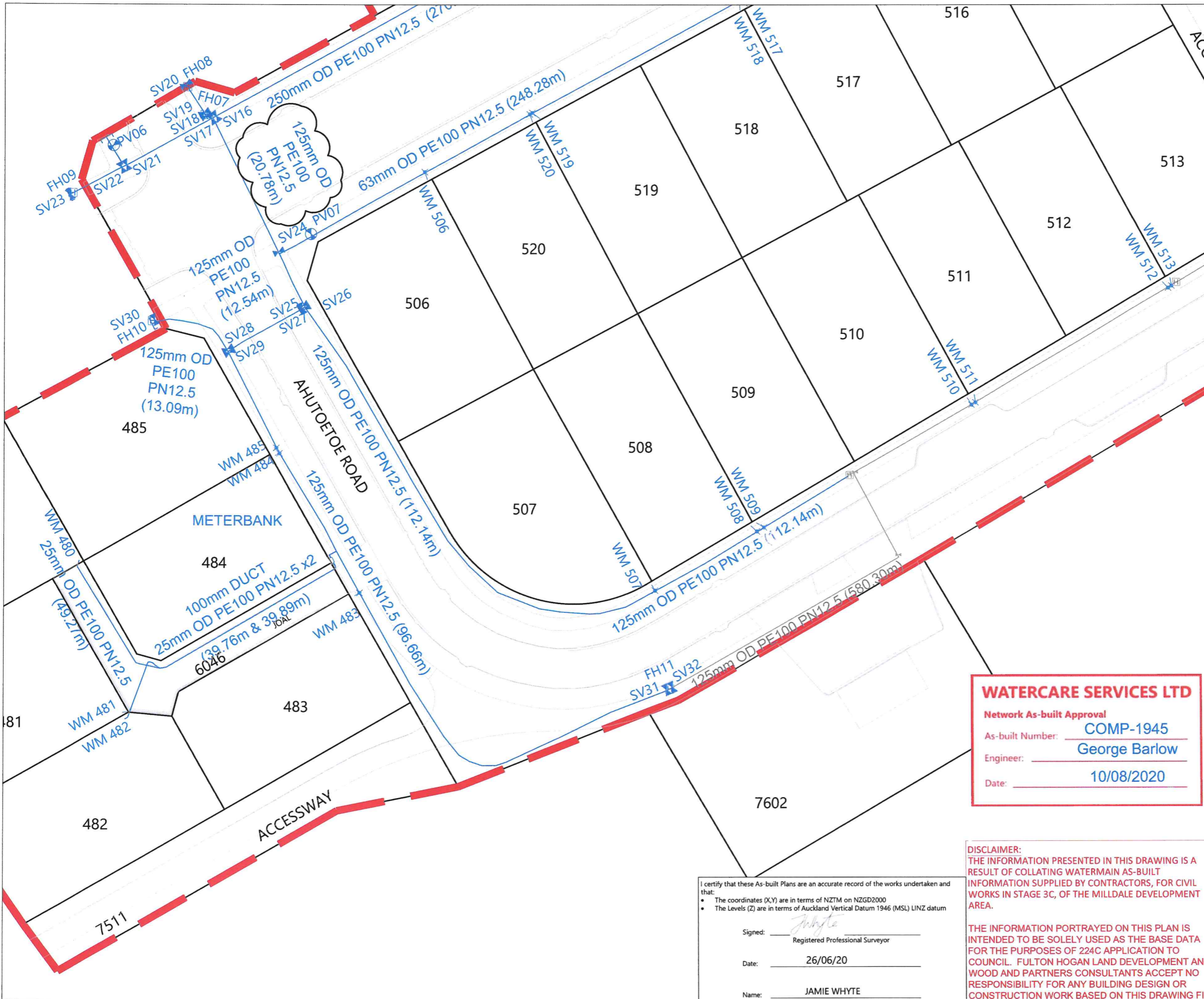

- NOTES**
1. ALL WORK AND MATERIALS COMPLIES WITH AC STANDARD FOR ENGINEERING DESIGN AND CONSTRUCTION.
 2. PIPE BEDDING COMPLIES WITH AC STD DETAIL DRAWING 18000 SHEET 4.4 UNLESS OTHERWISE NOTED.
 3. WATERMANS ARE AN AVERAGE 0.6m BELOW GROUND IN BERMS AND 0.9m BELOW GROUND UNDER ROADS. HARDFILL BACKFILLED BENEATH ROAD CROSSINGS.
 4. PIPE SIZES SHOWN ARE EXTERNAL DIAMETER.
 5. LOT BOUNDARIES ARE SUBJECT TO FINAL SURVEY.
 6. ASBUILT DATA HAS BEEN SOURCED FROM A COMBINATION OF WOODS SURVEY MEASURED DATA AND CONTRACTOR RECEIVED DATA.

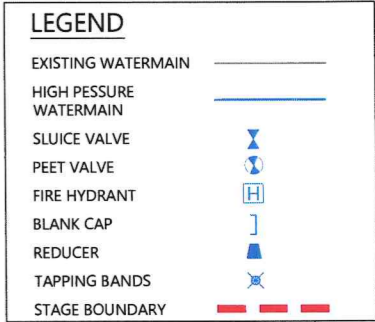

REVISION DETAILS	BY	DATE
1 ISSUED FOR INFORMATION	KR	25/06/20
2 WATERMAIN SIZE AMENDED	SK	05/08/20

SURVEYED	WOODS	WOODS Ltd LEVEL 1 BUILDING B 8 NUGENT STREET, GRAFTON AUCKLAND 1023
DESIGNED	NM	
DRAWN	HP	
CHECKED	EY	09 308 9229
APPROVED	JW	WOODS.CO.NZ

WATERCARE SERVICES LTD
 Network As-built Approval
 As-built Number: COMP-1945
 Engineer: George Barlow
 Date: 10/08/2020



**MILLDALE
STAGE 3C**

**WATERMAIN
ASBUILT PLAN
SHEET 6 of 6**

STATUS	AS-BUILT	REV
SCALE	1 : 500 @ A3	2
COUNCIL	AUCKLAND COUNCIL	
DWG NO	P18-305-03C-605-AB	

I certify that these As-built Plans are an accurate record of the works undertaken and that:

- The coordinates (X,Y) are in terms of NZTM on NZGD2000
- The Levels (Z) are in terms of Auckland Vertical Datum 1946 (MSL) LINZ datum

Signed: J Whyte
 Registered Professional Surveyor
 Date: 26/06/20
 Name: JAMIE WHYTE

DISCLAIMER:
 THE INFORMATION PRESENTED IN THIS DRAWING IS A RESULT OF COLLATING WATERMAIN AS-BUILT INFORMATION SUPPLIED BY CONTRACTORS, FOR CIVIL WORKS IN STAGE 3C, OF THE MILLDALE DEVELOPMENT AREA.

THE INFORMATION PORTRAYED ON THIS PLAN IS INTENDED TO BE SOLELY USED AS THE BASE DATA FOR THE PURPOSES OF 224C APPLICATION TO COUNCIL. FULTON HOGAN LAND DEVELOPMENT AND WOOD AND PARTNERS CONSULTANTS ACCEPT NO RESPONSIBILITY FOR ANY BUILDING DESIGN OR CONSTRUCTION WORK BASED ON THIS DRAWING FILE.